

Ultra-elegant Gigabit IP Phone

SIP VP-T49G



Quick Start Guide (V80.11)

Packaging Contents

The following items are included in your package. If you find anything missing, contact your system administrator.

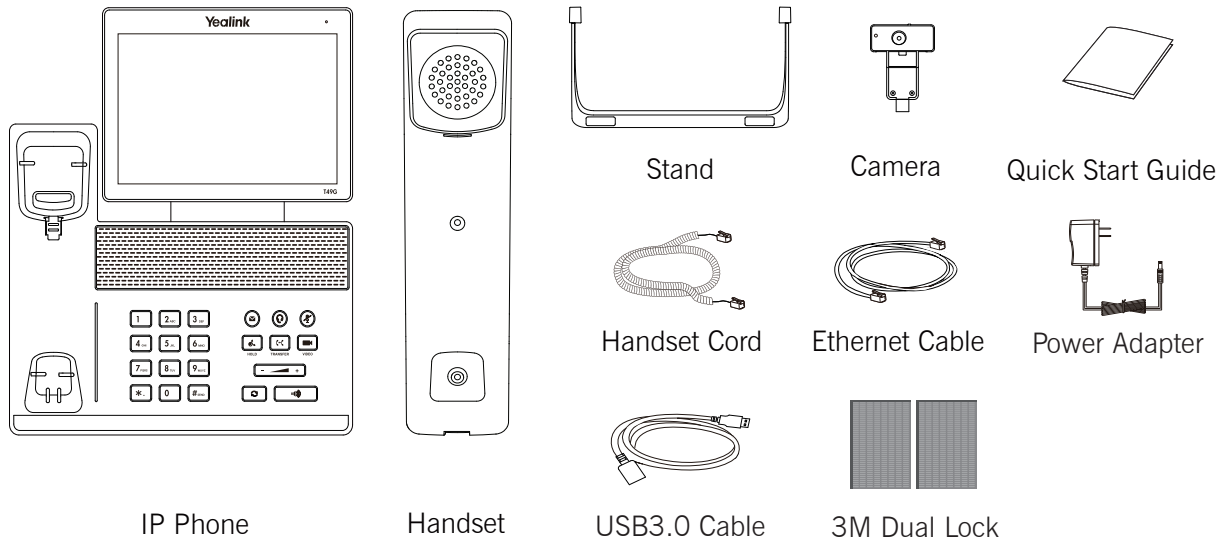

Assembling the Phone

1. Attach the stand, as shown below:

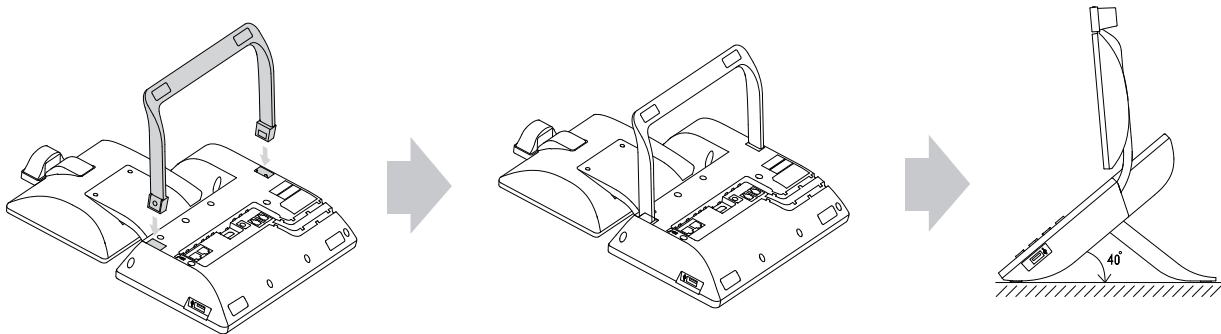

2. Insert the camera, as shown below:

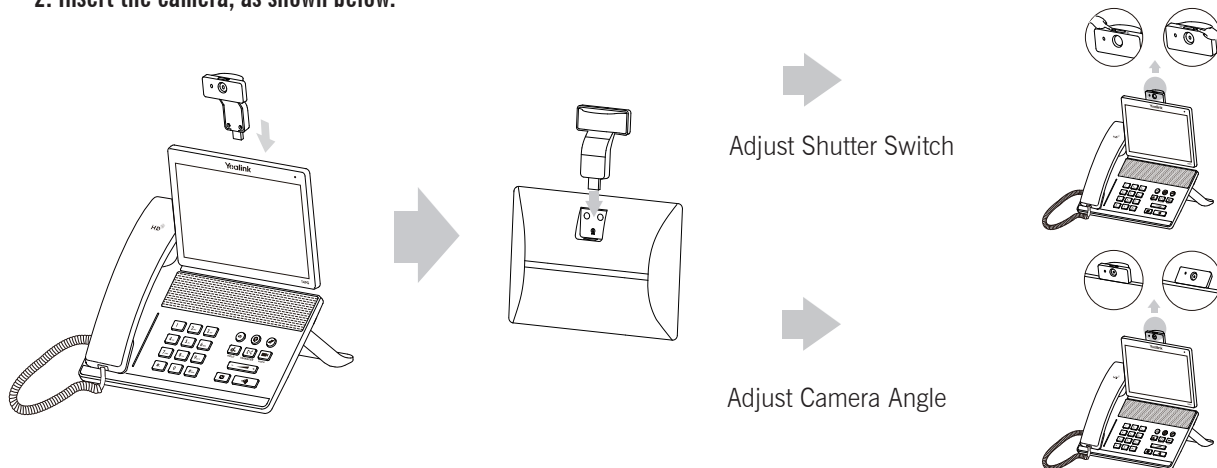

3. Connect the handset and optional headset, as shown below:

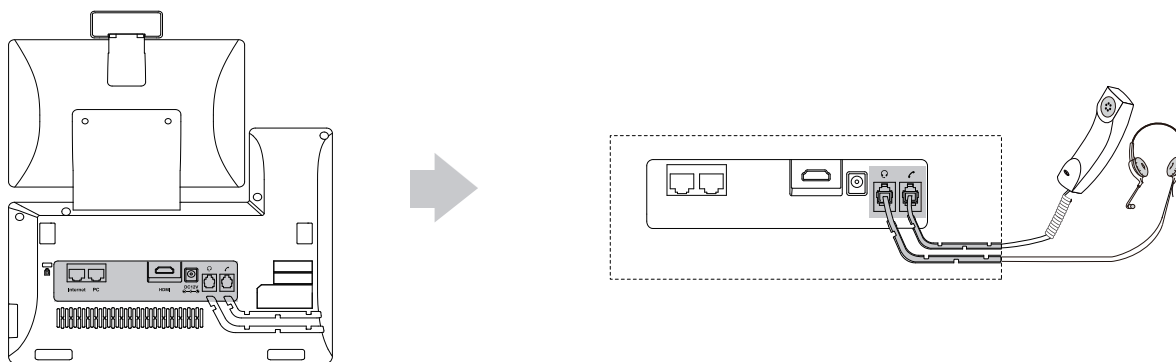

Note: The headset should be purchased separately.

4. Connect the optional USB flash drive, as shown below:

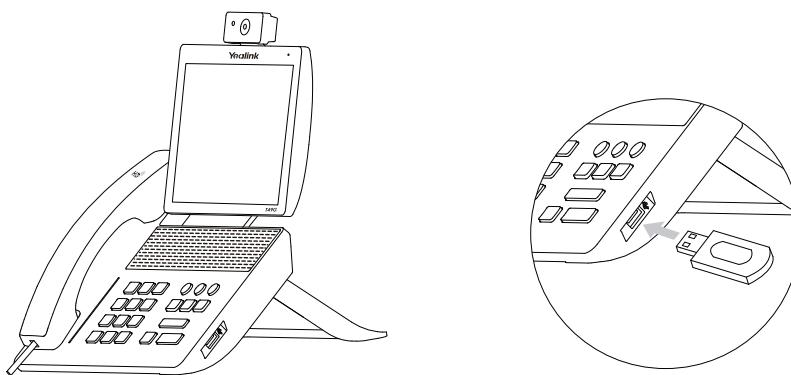

5. Connect the external monitor and attach the camera to the external monitor, as shown below:

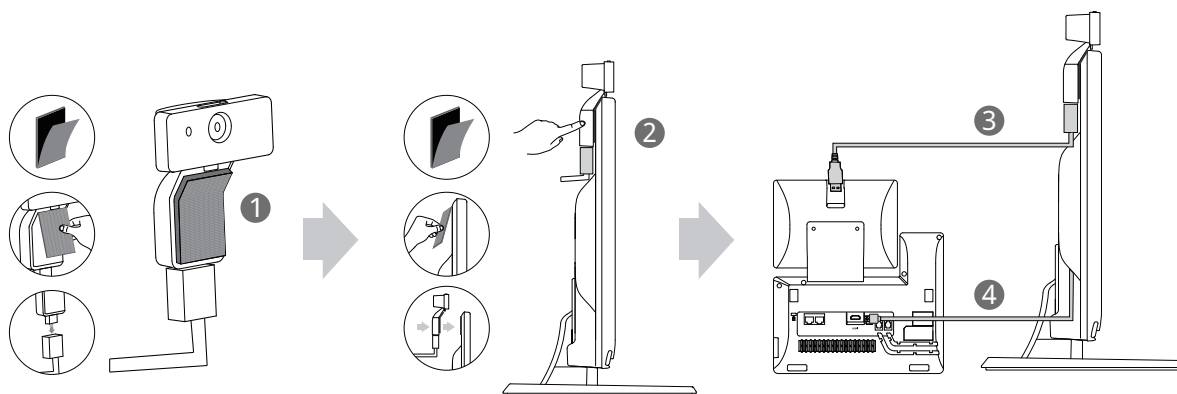

- Steps :
- 1 Remove one piece of the fastener's liner; take the gap of the camera as the touchline and attach to the camera from the top; connect one end of the USB3.0 cable to the camera.
 - 2 Remove the other piece of the fastener's liner; attach to the external monitor; attach the camera to the external monitor by pressing two sides of Dual Lock together. Make sure the camera is vertical and not askew otherwise the near-site video image will be crooked. You are advised to attach the camera to the external monitor whose back is straight.
 - 3 Connect the other end of the USB3.0 cable to the IP phone.
 - 4 Connect one end of the HDMI cable to the HDMI port on the phone, and connect the other end to the HDMI port on the external monitor.

6. Connect the AC power, as shown below:

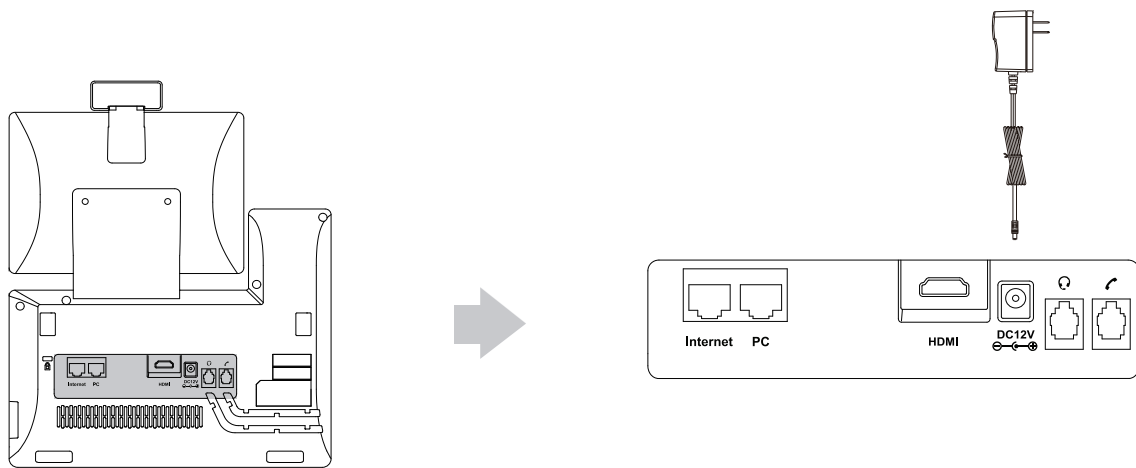

Note: The IP phone should be used with Yealink original power adapter (12V/2A) only.

7. Connect to the network, as shown below:

You have two options for network connection. You can select one of them according to the current office environment.

a) Connect to the wired network:

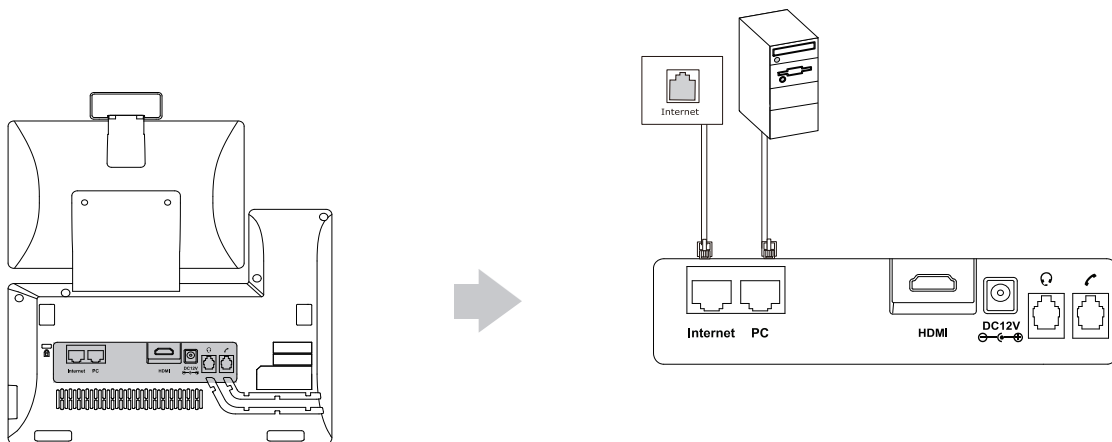

b) Connect to the wireless network:

1) Tap  -> **Basic** -> **Wi-Fi**.

2) Tap **On** from the radio box of **Wi-Fi**.

The phone will automatically search for available wireless networks in your area.

3) Select an available wireless network from the list of networks.

4) If the network is secure, enter its password in the **PIN** field.

5) Tap **OK** to connect to the wireless network.

Hardware Component Instructions

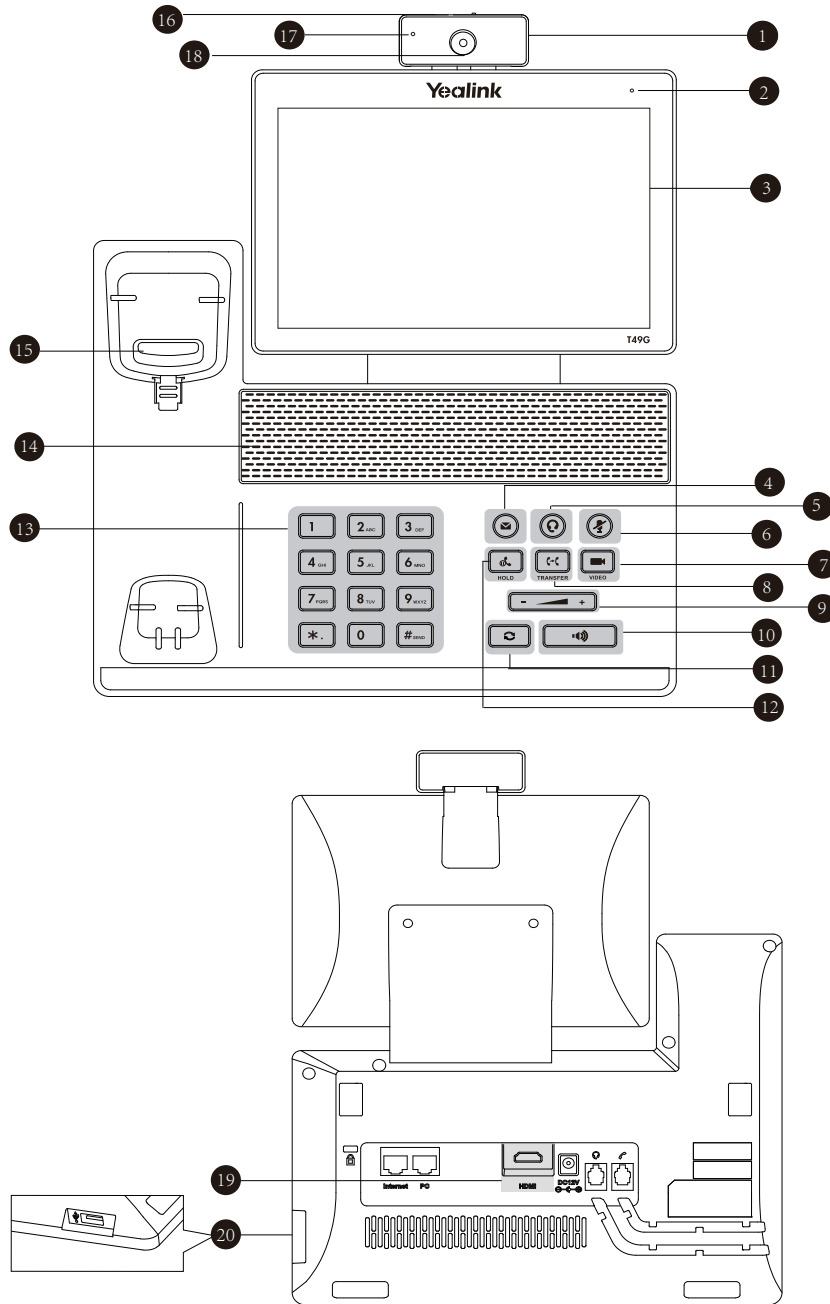

Item	Item	Item
1 Camera	8 TRANSFER Key	15 Hookswitch
2 Power Indicator LED	9 Volume Key	16 Shutter Switch
3 Touch Screen	10 Speakerphone Key	17 Camera Indicator LED
4 MESSAGE Key	11 REDIAL Key	18 Camera Lens
5 HEADSET Key	12 HOLD Key	19 HDMI port
6 MUTE Key	13 Keypad	20 USB2.0 port
7 VIDEO Key	14 Speaker	

Startup

After the IP phone is connected to the network and supplied with power, it automatically begins the initialization process. After startup, the phone is ready for use. You can configure the phone via web user interface or phone user interface.

Welcome

initializing... Please wait

Configuring Your Phone

Configuring via web user interface

Accessing the web user interface:

1. Tap  -> **Status** when the phone is idle to obtain the IP address of the phone.
2. Open a web browser on your computer, enter the IP address into the address bar (e.g., "http://192.168.0.10" or "192.168.0.10"), and then press **Enter**.
3. Enter the user name (default: admin) and password (default: admin) in the login page and click **Confirm**.

Network Settings: Click on **Network->Basic->IPv4 Config**

You can configure the network settings in the following ways:

DHCP: By default, the phone attempts to contact a DHCP server in your network to obtain its valid network settings, e.g., IP address, subnet mask, gateway address and DNS address.

Static IP Address: If the phone cannot contact a DHCP server for any reason, you need to configure IP address, subnet mask, gateway address, primary DNS address and secondary DNS address for the phone manually.

PPPoE: If you are using an xDSL modem, you can connect your phone to the Internet via PPPoE mode. Contact the ITSP for the user name and password.

Note: The IP phone also supports IPv6, but IPv6 is disabled by default.

Account Settings: Click on **Account->Register->Account X (X=1,2,3...15,16)**

Parameters of the account:

Register Status:	It shows the register status of the current account.
Line Active:	You can select Enabled/Disabled to enable/disable the account.
Label:	It is shown on the touch screen to identify the account.
Display Name:	It is shown as Caller ID when placing a call.
Register Name:	It is an authenticated ID for authentication provided by ITSP (required).
User Name:	It is provided by ITSP for registration (required).
Password:	It is provided by ITSP for registration (required).
Server Host:	It is provided by ITSP for registration (required).

Register status icons on the touch screen:



(Green) Registered



(Gray) Register Failed



(Green and Flashing) Registering

Note: Check with your system administrator if any error appears during the registration process or a specific configuration is required for your registration.

Configuring via phone user interface

Network Settings:

When the phone is idle, tap -> **Advanced** (default password: admin)-> **Network**-> **WAN Port/VLAN/Webserver Type /802.1x/ VPN/ LLDP/CDP/NAT** to configure the network.

Account Settings:

When the phone is idle, tap -> **Advanced** (default password: admin)-> **Account** to configure the account.

Using Your Phone

Status Icons

The icons on the status bar of the touch screen give information about phone:

Icons	Description
	Shows that camera is not detected.
(White)	Shows that Wi-Fi is turned on.
(Green)	Shows that the phone is connected to wireless network successfully.
	Shows that the phone fails to connect to wireless network.
	Shows that network is unavailable.
(White)	Shows that Bluetooth is turned on.
(Green)	Shows that Bluetooth headset is paired successfully.
(Green)	Shows that Bluetooth-Enabled mobile phone is paired successfully.
	Shows that the phone is locked.
	Shows that "Forward" is turned on.
	Shows that "Do Not Disturb" is turned on.
	Shows that "Auto Answer" is turned on.
	Shows that you have missed calls.
	Shows that you have unread voice mails.
	Shows that you have unread text messages.
	Shows that ringer volume is 0.
	Shows that a USB flash drive is detected.
	Shows that an external monitor is connected.

Navigating the Touch Screen

- To enter the main menu, tap .
- To return to the idle screen, tap .
- To go back to the previous menu, tap .
- To select an item, tap the item.
- Drag up and down to scroll.
(You can wait for the scrolling to come to a stop, or touch the screen to stop it immediately.)

Entering and Updating Data

To use onscreen keyboard:

1. Tap the field you want to edit, the onscreen keyboard will display on the touch screen:

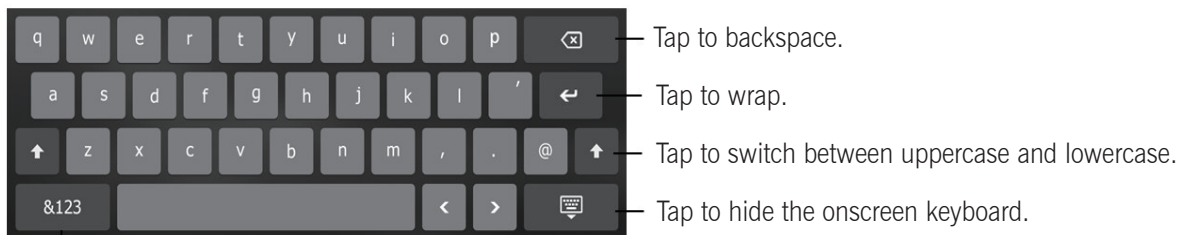

Tap to switch among input modes. Tap to move the cursor.

2. When you finish entering, tap .

3. Tap the **Save** soft key to accept the change.

To use keypad:

Dial or enter number.

To select a field option:

Tap the field name, tap the desired option from the pop-up dialog box.

Control Center and Notification Center

Swipe down from the top of the screen to enter the control center and the notification center.

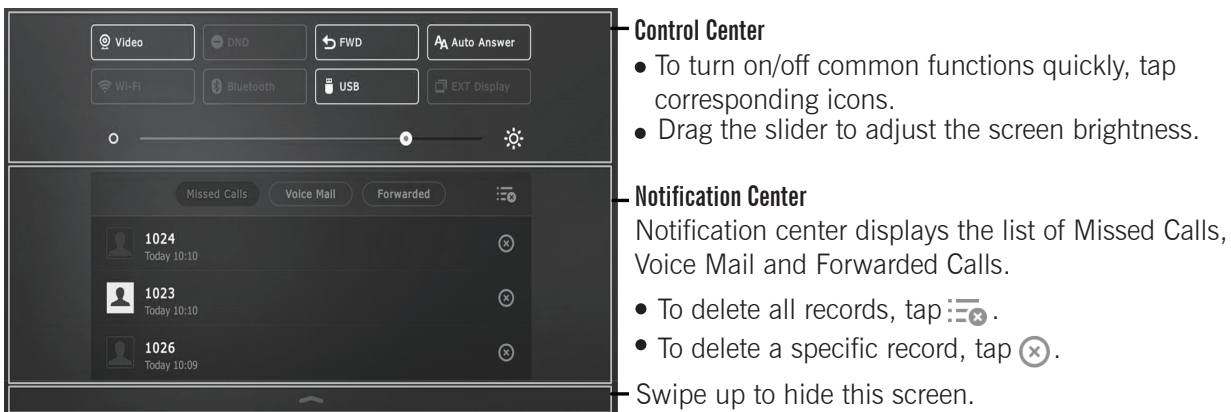

Basic Call Features

Placing a Video/Voice Call

Using the handset:

1. Pick up the handset.
2. Enter the number, and then tap the **Send** soft key.

Using the speakerphone:

1. With the handset on-hook, press .
2. Enter the number, and then tap the **Send** soft key.

Using the headset:

1. With the headset connected, press  to activate the headset mode.
2. Enter the number, and then tap the **Send** soft key.

Answering a Video/Voice Call

Using the handset:

Pick up the handset.

Using the speakerphone:

Press .

Using the headset:

Press .

Controlling Video During a Call

To change the video view:

Tap  or .

To turn on/off video during a call:

- Swipe down from the top of the screen to enter the control center, tap **Video** to turn on/off the video.
- Press .
- Adjust the shutter switch.

Ending a Video/Voice Call

Using the handset:

Hang up the handset or tap the **EndCall** soft key.



Using the speakerphone:

Press  or tap the **EndCall** soft key.



Using the headset:

Tap the **EndCall** soft key.

Redial

- Press  to enter the **Placed Calls** list, and then tap the desired entry.
- Press  twice when the phone is idle to dial out the last dialed number.

Call Mute and Un-mute



- Press  to mute the microphone during a call.
- Press  again to un-mute the call.

Call Hold and Resume

To place a call on hold:

Press  or tap the **Hold** soft key during an active call.

To resume the call, do one of the following:

- If there is only one call on hold, press  or tap the **Resume** soft key.
- If there is more than one call on hold, tap the call you want to resume, and press  or tap the **Resume** soft key.



Call Transfer

You can transfer a call in the following ways:

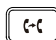

Blind Transfer

1. Press  or tap the **Transfer** soft key during a call. The call is placed on hold.
2. Enter the number you want to transfer to.
3. Press  or tap the **Transfer** soft key.

Semi-Attended Transfer

1. Press  or tap the **Transfer** soft key during a call. The call is placed on hold.
2. Enter the number you want to transfer to, and then press .
3. Press  or tap the **Transfer** soft key when you hear the ring-back tone.

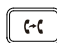
Attended Transfer

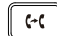
1. Press  or tap the **Transfer** soft key during a call. The call is placed on hold.
2. Enter the number you want to transfer to, and then press .
3. Press  or tap the **Transfer** soft key when the second party answers.

Call Forward

To enable call forward:

1. When the phone is idle, tap  -> **Features**-> **Call Forward**.
2. Select the desired forward type:
 - Always Forward**---Incoming calls are forwarded unconditionally.
 - Busy Forward**---Incoming calls are forwarded when the phone is busy.
 - No Answer Forward**---Incoming calls are forwarded if not answered after a period of time.
3. Enter the number you want to forward to. For **No Answer Forward**, tap the **After Ring Time** field, and then tap the desired ring time to wait before forwarding.
4. Tap the **Save** soft key to accept the change.

Call Conference

1. Tap the **Conference** soft key during an active call. The call is placed on hold.
2. Enter the number of the second party, and then press  or tap the **Conference** soft key.
3. Tap the **Conference** soft key again when the second party answers. All parties are now joined in the conference.
4. Tap the **EndCall** soft key to disconnect all parties.

Note: You can split the conference call into two individual calls by tapping the **Split** soft key.

Voice Message



Message waiting indicator on the idle screen indicates that one or more voice messages are waiting at the message center. The power indicator LED slowly flashes red.

To listen to voice messages: (Ensure the voice mail code is already configured on the phone.)

1. Swipe down from the top of the screen to enter the notification center, tap **Voice Mail** and select the desired item, or press .
2. Follow the voice prompts to listen to your voice messages.

Customizing Your Phone

Call History



1. When the phone is idle, tap , and select the desired call list on the left.
2. Drag up and down to scroll.
3. Tap  after the desired entry, and then you can do the following:
 - Tap **Send** to place a call.
 - Tap **Add** to add the entry to the local directory.
 - Tap **Edit** to edit the phone number of the entry before placing a call.
 - Tap **Blacklist** to add the entry to the blacklist.
 - Tap **Delete** to delete the entry from the list.

Contact Directory



To add a contact:

1. When the phone is idle, tap , and select the desired group.
2. Tap **Add** to add a contact.
3. Enter a unique contact name in the **Name** field and contact numbers in the corresponding fields.
4. Tap the **Save** soft key to accept the change.

To edit a contact:



1. When the phone is idle, tap , and select the desired group.
2. Tap  after the desired contact.
3. Edit the contact information.
4. Tap the **Save** soft key to accept the change.

To delete a contact:

1. When the phone is idle, tap , and select the desired group.
2. Tap  after the desired contact and then tap **Delete**.
3. Tap **OK** when the touch screen prompts "Delete selected item?".

Note: You can add contacts from call history easily. For more information, refer to **Call History** above.

Volume Adjustment

- Press  during a call to adjust the receiver volume of the handset/speakerphone/headset.
- Press  when the phone is idle to adjust the ringer volume.

About us

Founded in 2001, Yealink, a leading provider of VoIP Phone and IP communication solutions, has been focusing on VoIP products characterized by reliable quality, easy deployment and affordable price for more than a decade. Today, customers from over 140 countries rely on Yealink as the backbone of global collaboration to extend the value of network communications.

More about Yealink

Since 2001, Yealink has continued to develop state-of-the art, hi-tech VoIP communication terminals that include IP video phones, IP phones and USB phones. With a worldwide market in more than 140 countries, the company has also established a first-class international service network.

Our priorities are quality, functionality, ease-of-use, customer support and competitive pricing. To provide new solutions for the future in this fast-evolving sector, Yealink's large, talented and highly-experienced VoIP R&D team is totally committed to the pursuit of excellence.

To date, we have passed more than 80 interoperability tests and meet certification requirements set by leading VoIP system and platforms. Yealink works in close partnership with T-Mobile, Telefonica, Portugal Telecom and other leading telecommunication service providers.



YEALINK NETWORK TECHNOLOGY CO.,LTD.
Web: www.yealink.com
Addr: 4th-5th Floor, South Building, No.63
Wanghai Road, 2nd Software Park,
Xiamen, China(361008)
Copyright©2015Yealink Inc.All right reserved.